

Land known as "Thomas Clark's"
now
Henry D. Jayne

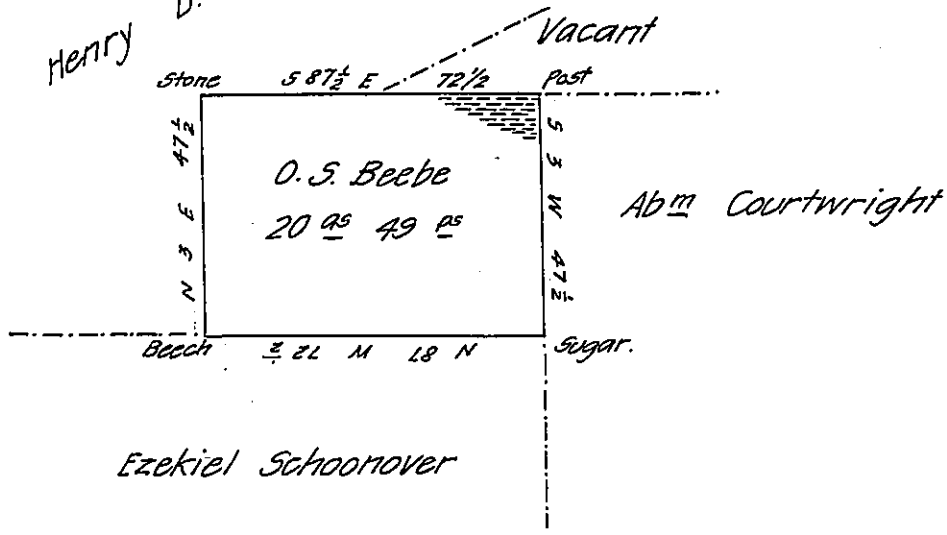

In pursuance of a Warrant dated the 7th day of March A.D. 1851. Sur-
veyed the 26th day of August A.D. 1851 to Orin S. Beebe the above described tract
of land situate in Scott Township Wayne County Containing Twenty acres and forty
nine perches and allowance of ~~one~~ Six pr. Cent for Roads &c.

To J. Porter Brawley Esquire

E. W. Weston

Surveyor General.

Surveyor for Wayne County

Note, The timber was felled some years since on a small part of the above
described land near the N.E. Corner and land partly cleared but I think it is
not worthy of being called Improved

E. W. Weston

IN TESTIMONY that the above is a copy of the original remaining on file in
the Department of Internal Affairs of Pennsylvania, made
conformably to an Act of Assembly approved the 16th day of
February, 1833, I have hereunto set my Hand and caused
the Seal of said Department to be affixed at Harrisburg,
this tenth day of March 1908

Henry Howells
Secretary of Internal Affairs.